

## LEARNING AREA: **MATHEMATICAL ACTIVITIES. GRADE 4**

TERM \_\_\_\_\_ (MID) (END) (CONTINUOUS) YEAR \_\_\_\_\_

NAME \_\_\_\_\_ GENDER \_\_\_\_\_ ATTENDANCE \_\_\_\_\_ UPI \_\_\_\_\_

The teacher to fill the grid below after marking the learner's work. (50marks)

### ASSESSMENT RUBRIC

Exceeds Expectation 48-50	Meets Expectation 25-47	Approaches Expectation 11-24	Below Expectation 0-10

### NUMBERS

1. Write the numbers represented in the abacus below

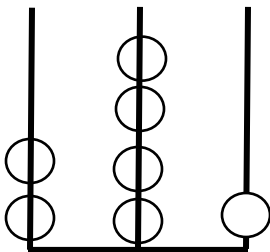

a) H      T      O

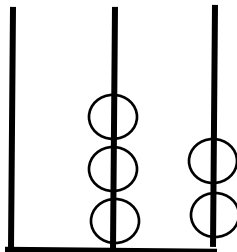

b) H      T      O

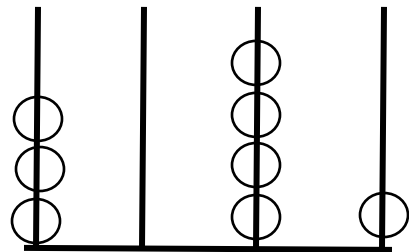

c) Th      H      T      O

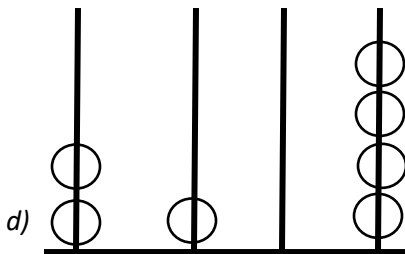

d) Th      H      T      O

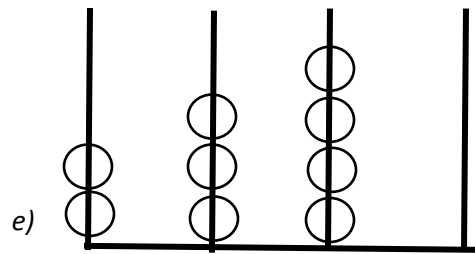

e) Th      H      T      O

2. What is the total value of the underlined digits? (5marks)

- a) 254
- b) 6430
- c) 1943
- d) 2560
- e) 1438

3. Write in symbols

- a) Five thousand three hundred and thirty three \_\_\_\_\_
- b) Ten thousand \_\_\_\_\_
- c) Nine thousand, nine hundred and ninety \_\_\_\_\_

4. Write in words

8888 \_\_\_\_\_

989 \_\_\_\_\_

# LECLERE BARAKA MEMORIAL SCHOOL INTERNAL ASSESSMENTS

5. Arrange the numbers from the largest to the smallest (2marks)

a) 138, 381, 831, 813, 183, 318

b) 469, 946, 496, 649, 694, 964

6. Round off the following numbers to the nearest 10 (5marks)

a) 146 \_\_\_\_\_ b) 89 \_\_\_\_\_ c) 3 \_\_\_\_\_ d) 27 \_\_\_\_\_, e) 387 \_\_\_\_\_

7. List the first 6 multiples of 7 (3mark)

\_\_\_\_\_, \_\_\_\_\_, \_\_\_\_\_, \_\_\_\_\_, \_\_\_\_\_, \_\_\_\_\_

8. List all the even numbers between 10 and 20 (2marks)

-----

9. List the four odd numbers after 15 (2marks)

15, \_\_\_\_\_, \_\_\_\_\_, \_\_\_\_\_, \_\_\_\_\_

10. Complete the patterns;

a) 2, 4, 6, 8, \_\_\_\_\_, \_\_\_\_\_, \_\_\_\_\_

b) 23, 25, 27, \_\_\_\_\_, \_\_\_\_\_, \_\_\_\_\_

c) 89, 87, 85, \_\_\_\_\_, \_\_\_\_\_, \_\_\_\_\_

d) 61, 59, 57, \_\_\_\_\_, \_\_\_\_\_, \_\_\_\_\_

11. Lake View Primary school planted **2365** tree seedlings in the month of June. In the month of July the school planted another **3542** tree seedlings. How many tree seedlings did the school plant in the two months altogether? \_\_\_\_\_

12. Round off each numbers to the nearest 10 then get the sum;

**79+384=** \_\_\_\_\_ (1mark)

13. Mr. Kisotu had 8947 bags of wheat. He sold 2715 bags of wheat in order to pay school fees for his children. How many bags of wheat remained? (1mark) \_\_\_\_\_

14. Work out;

$$\begin{array}{r} \text{a) } 83 \\ -15 \\ \hline \end{array}$$

$$\begin{array}{r} \text{b) } 5392 \\ - 175 \\ \hline \end{array}$$

15. Complete the following

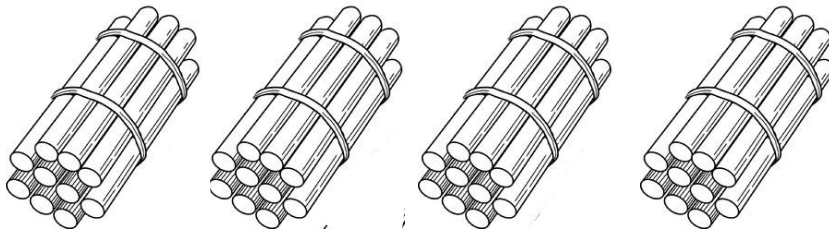

\_\_\_\_\_ ten is \_\_\_\_\_ x10= \_\_\_\_\_

16. Work out the following (5mark)

a)  $8 \times 7 =$  \_\_\_\_\_ b)  $8 \times 30 =$  \_\_\_\_\_

c) **45**

  5  

d)  $45 \div 5 =$  \_\_\_\_\_

e)  $4 \sqrt{95}$

## MEASUREMENT

Study the pictures below and use them to answer the questions that follow;



Dress Shs 500



Shoes Shs 1000



Handbag Shs 500



Belt Shs 100

17. How much money did Jane pay after buying a dress, a pair of shoes and a handbag? \_\_\_\_\_ (1 mark)
18. Nyokabi bought a handbag and a belt. She gave the shopkeeper Shs 1000 note. How much balance did she get? \_\_\_\_\_ (2 marks)
19. Nailantei bought two dresses, a pair of shoes, a handbag and a belt. How much did she pay altogether? \_\_\_\_\_ (two marks)

## GEOMETRY

20.

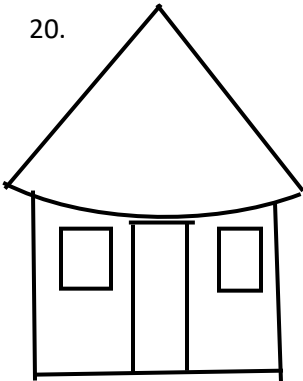

How many shapes are used to make the house? \_\_\_\_\_ shapes.

21. Colour the following to create a pattern

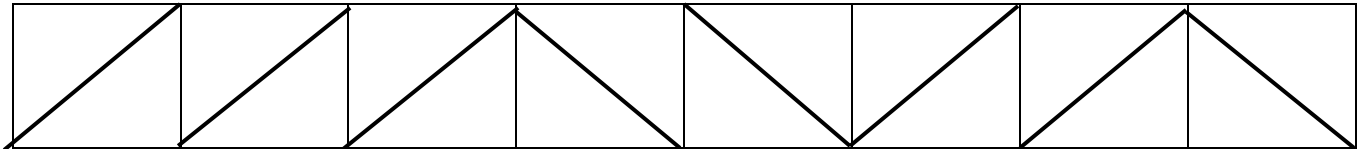

22. Complete the pattern

